



























# 过渡接头 ADAPTER

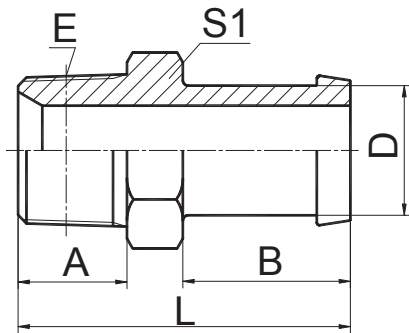

## 1TX-SP(IN)

英锥管外螺纹  
BSPT MALE

代号 PART NO.	螺纹 THREAD	尺寸 DIMENSION					
	E	D	A	B	L	S1	
1TX-06-12SP(IN)	R3/8"X19	3/4"	15	28	51	22	
1TX-08-12SP(IN)	R1/2"X14	3/4"	20	28	56	22	
1TX-12SP(IN)	R3/4"X14	3/4"	20	28	58	27	
1TX-12-16SP(IN)	R3/4"X14	1"	20	35	65	30	
1TX-16-12SP(IN)	R1"X11	3/4"	25.5	28	64.5	36	
1TX-16SP(IN)	R1"X11	1"	25.5	35	71.5	36	
1TX-16-20SP(IN)	R1"X11	1.1/4"	25.5	35	71.5	36	
1TX-16-24SP(IN)	R1"X11	1.1/2"	25.5	40	78.5	41	
1TX-20-12SP(IN)	R1.1/4"X11	3/4"	26.5	28	67.5	46	
1TX-20-16SP(IN)	R1.1/4"X11	1"	26.5	35	74.5	46	
1TX-20SP(IN)	R1.1/4"X11	1.1/4"	26.5	35	74.5	46	
1TX-20-24SP(IN)	R1.1/4"X11	1.1/2"	26.5	40	79.5	46	
1TX-24-16SP(IN)	R1.1/2"X11	1"	26.5	35	76.5	50	
1TX-24-20SP(IN)	R1.1/2"X11	1.1/4"	26.5	35	76.5	50	
1TX-24SP(IN)	R1.1/2"X11	1.1/2"	26.5	40	81.5	50	
1TX-32-16SP(IN)	R2"X11	1"	30	35	82	65	
1TX-32-20SP(IN)	R2"X11	1.1/4"	30	35	82	65	
1TX-32-24SP(IN)	R2"X11	1.1/2"	30	40	87	65	
1TX-32SP(IN)	R2"X11	2"	30	44.5	91.5	65	

# 过渡接头 ADAPTER

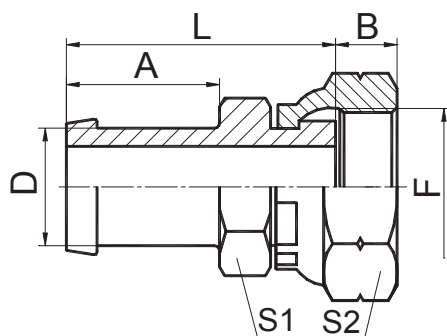

## 2XB-FIN

英管内螺纹平面  
BSP FEMALE FLAT

代号 PART NO.	螺纹 THREAD		尺寸 DIMENSIONS						
	E	F			A	B	L	S1	S2
2XB-12FIN	3/4"	G3/4"X14			28	13.5	50.5	27	41
2XB-16FIN	1"	G1"X11			35	15.5	58.5	32	41
2XB-20FIN	1.1/4"	G1.1/4"X11			35	15.5	63	41	50
2XB-24FIN	1.1/2"	G1.1/2"X11			40	17.5	68.5	46	55

Main Power Hydraulics Machinery Co.

<http://www.mainpowerhyd.com>

明力油壓機械工程

C-14

TEL:(852)2690 3509

FAX:(852)2690 3505



E-MAIL: [sales@mainpowerhyd.com](mailto:sales@mainpowerhyd.com)

# 过渡接头 ADAPTER

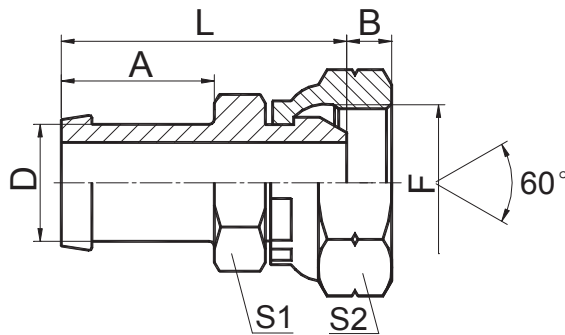

## 2XB-IN

英管内螺纹 60° 外锥  
BSP FEMALE 60° CONE

代号 PART NO.	螺纹 THREAD		尺寸 DIMENSIONS					
	E	F	A	B	L	S1	S2	
2XB-12IN	3/4"	G3/4"X14	28	11.7	43	27	41	
2XB-16IN	1"	G1"X11	35	11.7	62	32	41	
2XB-20IN	1.1/4"	G1.1/4"X11	35	11	68	41	50	
2XB-24IN	1.1/2"	G1.1/2"X11	40	13	73	46	55	
2XB-32IN	2"	G2"X11	44.5	20	80.5	60	70	

Main Power Hydraulics Machinery Co.

<http://www.mainpowerhyd.com>

明力油壓機械工程

C-15

TEL:(852)2690 3509

FAX:(852)2690 3505



E-MAIL: [sales@mainpowerhyd.com](mailto:sales@mainpowerhyd.com)