

Pressure Sensor industrial Heavy Duty with internal diaphragm

Accuracy 0,25 % and 0,5 %

Standard output 4...20 mA; 2-wire system
or 0...20 mA; 3-wire system
or 0...5 VDC; 3-wire system
or 0...10 VDC; 3-wire system

Features

High overload protection
Corrosion resistant ,stainless steel design
Highly resistant to shock and vibration
Good reproducibility



Applications

Development and laboratory,
Process engineering,
Plant and apparatus construction,
Hydraulics and pneumatics,

Model	SD-30	SD-32
Accuracy	0,5 % of full scale value	0,25 % of full scale value
Ranges in bar	0...0,1, ...0,25, ...0,4, ...0,6, 1, 1,6, 2,5, 4, 6, 10, 16, 25, 40, 60, 100, 160, 250, 400, 0...600, 1.000, 1.600, 2.500, 4.000 -0,6 / 0, -1 / 0, -1 / +0,6, -1 / +1,5, -1 / +3, -1 / +5, -1 / +9, -1 / +15, -1 / +24	
Overload limit	to 16 bar - 2,0 x from 25 to 600 bar - 2,0 x over 600 bar - 1,5 x	
Sensor element	from 0,1 to 16 bar piezoresistive, over 25 bar in Thin film	
Repeability	< 0,05 % full scale value	
Stability per year	< 0,2 % full scale value in rated conditions	
Case	CrNi steel	
Wetted parts	CrNi steel	
Pressur connection	SW 27 CrNi steel	
Electrical connection	plug according to DIN 43650 with junction box	
Power supply	10...30 VDC (14...30 VDC for output 0...10 V)	
Power consumption	Output 4...20 mA: signal currency	voltage output 8 mA
Temp.comp.range	0...80 °C	
Temp. influence	0,2 % / 10 K, zero point and measuring element	
Response time	(within 10% to 90% of full scale value)	
Protection type	IP 65 to EN 60529 /IEC 529	
Temperatures	Medium: -30°C up to 100°C, Ambient: -20°C up to 80°C	
Weight	0,2 kg	

Dimensions and Design

with internal diaphragm

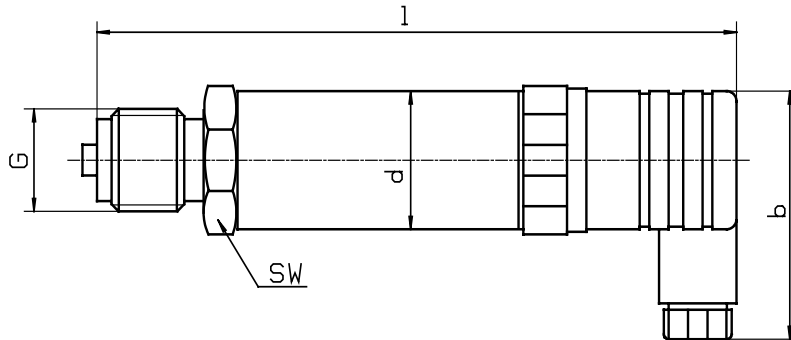

Electrical connection

Two-wire system

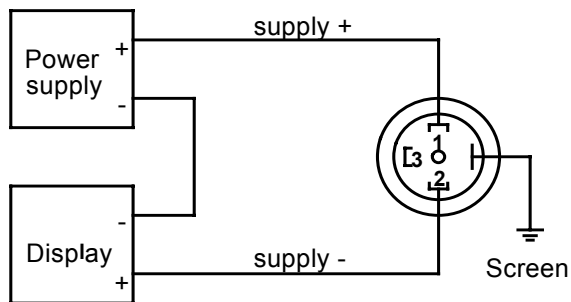

Three - wire system

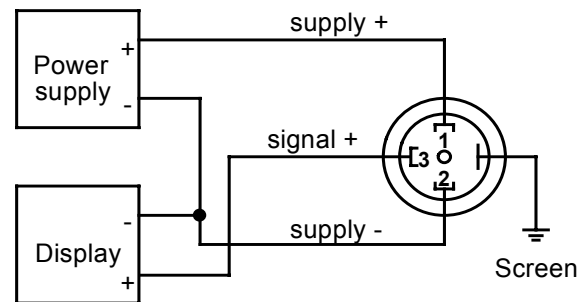

Dimensions in mm						
Model	b		d	l	SW	G
SD-30	48		27	133	27	G 1/2 B